

Sample System Layout

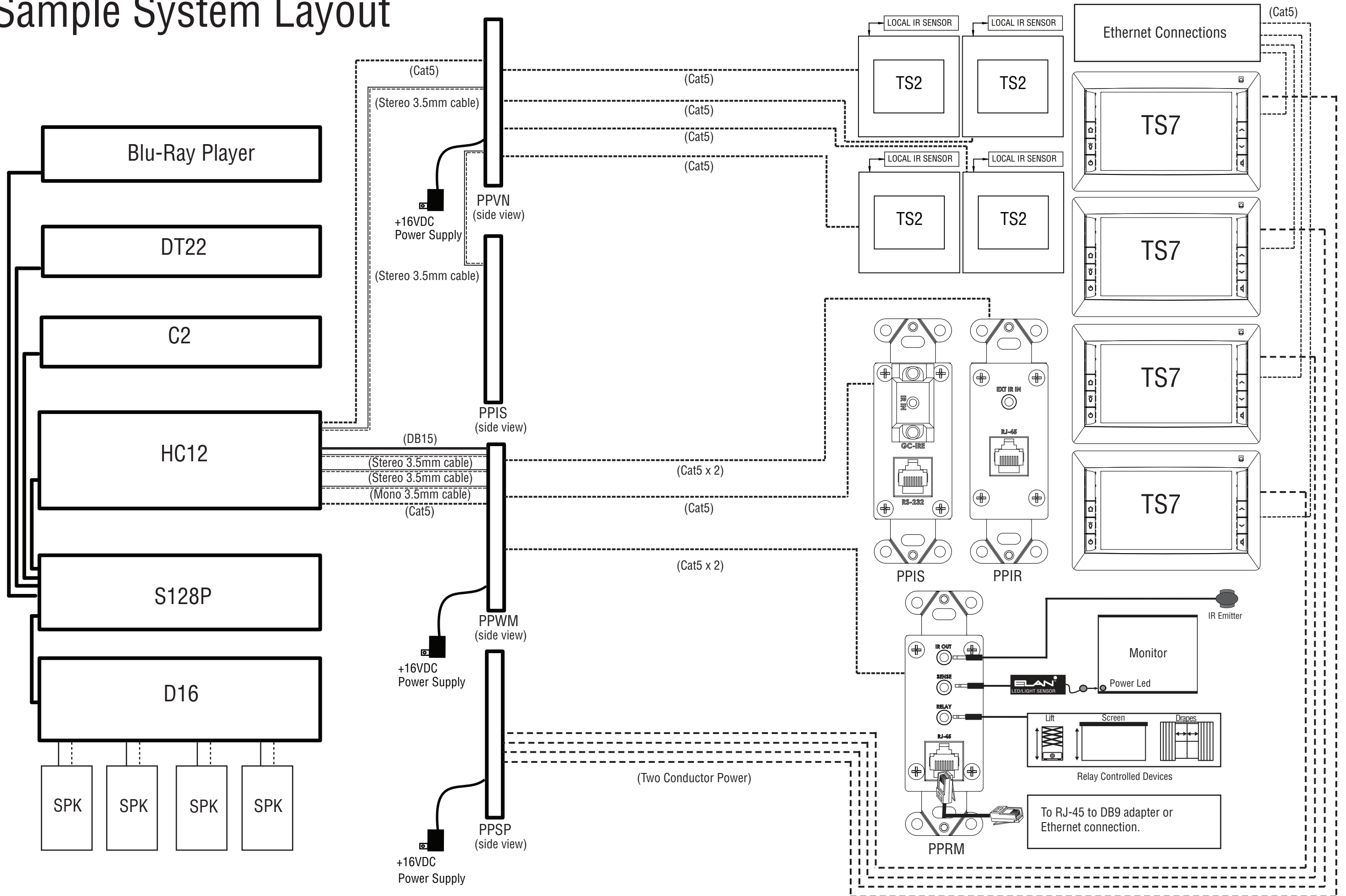

PPVN

Quick Install Guide

ELAN[®] VIANET PRECISION PANEL

Application: Provides power and ViaNet to and IR from four TS2s.

Connects to the ViaNet port on a rack mounted Home Controller or to the ViaNet punchdown of a PPCM when using can mounted controllers.

Location: Head-end

Wiring Basics: Cat5 connects to TS2s located in zones as well as to additional PPVNs and/or PPCM. Cat5 jumper from RJ-45 to PPWM.

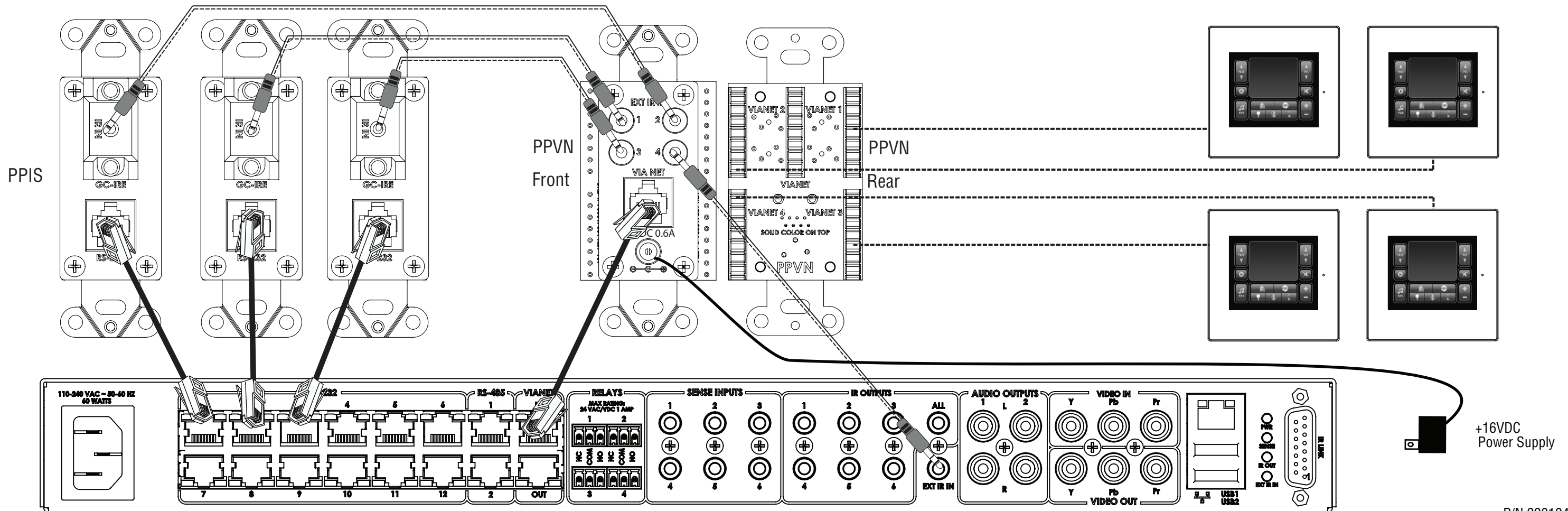
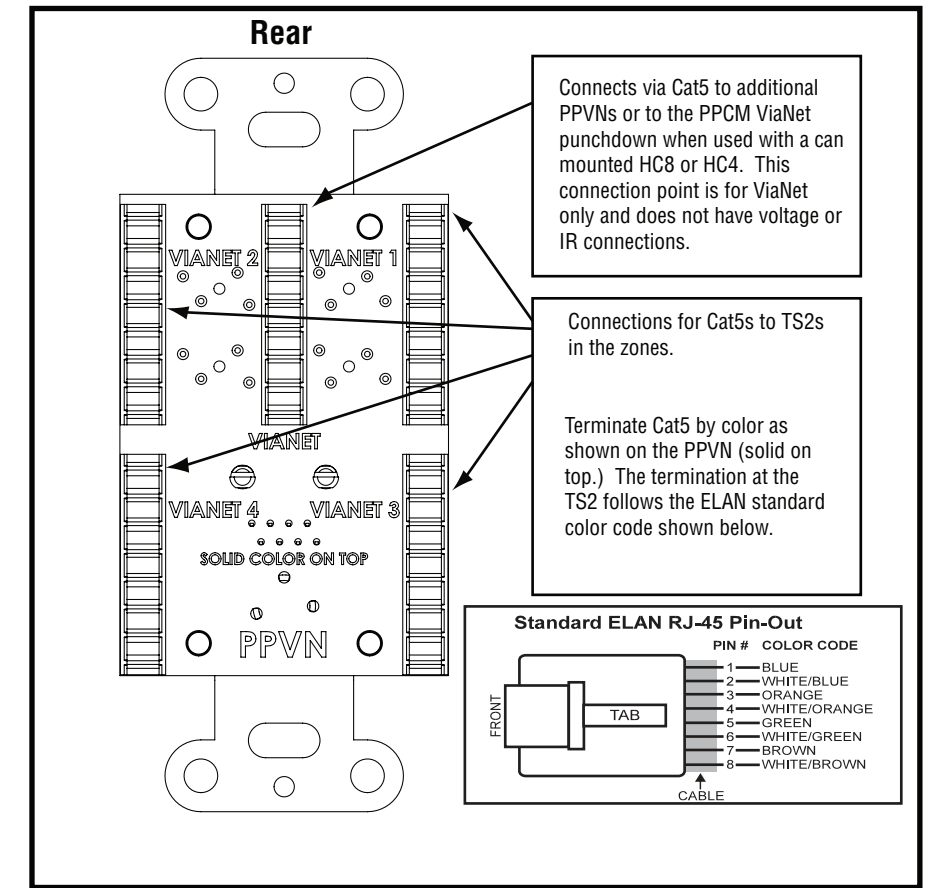
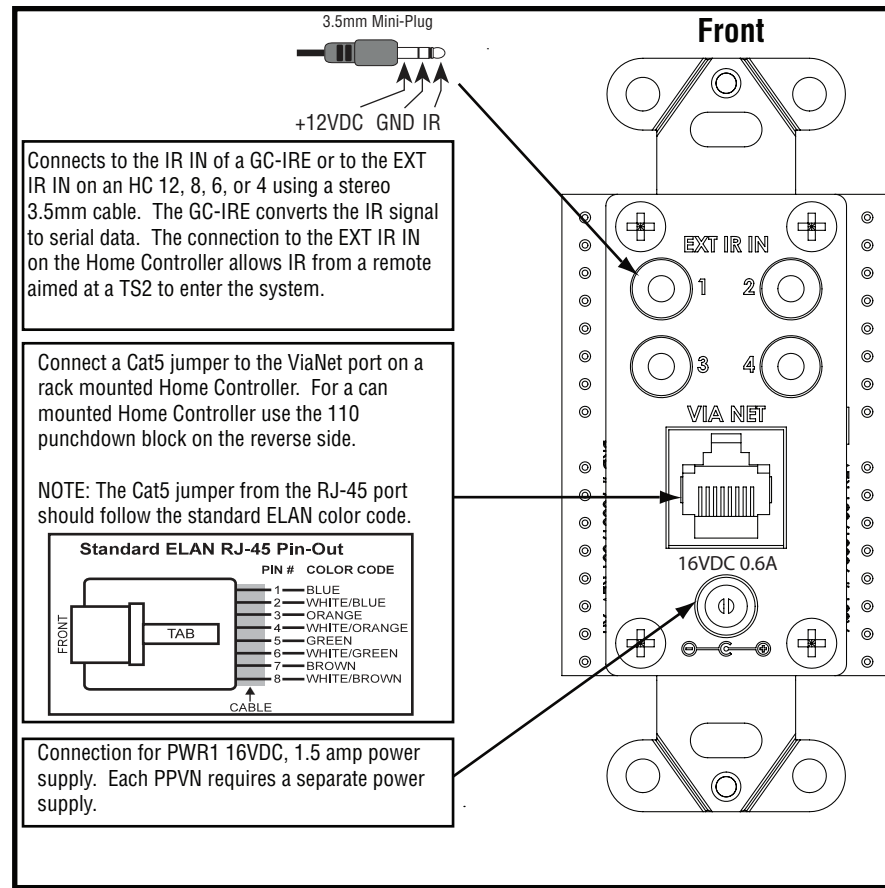

INSTR, INSTL, PPVN
LINEAR P/N 9901048 REV: B
INK: BLACK
MATERIAL: 60 LB WHITE PAPER
No. PAGES: 2 Pages (Front and Back)
SCALE: 1-1
SIZE: 17.0 x 11.0
FOLDING: SEE ARTWORK • “PPVN” SHOWS ON FRONT
Final Dimension: 4.25 x 2.75
NOTE: ARTWORK CREATED BY ELAN HOME SYSTEMS
THIS MANUAL MUST BE RoHS COMPLIANT

